

ISSUED: DECEMBER 27, 2004

EFFECTIVE: JANUARY 1, 2005

LOCAL SERVING AREAS AND LOCAL CALLING AREAS

3.1 GENERAL

Residence Local Service provides the Customer with an access line, optional features, and usage within a Local Calling Area for the transmission of two-way interactive switched voice or data communications. This service is offered within certain areas of Utah as defined in maps accompanying this Price List. The Company reserves the right to offer services under a phased-in schedule such that the local serving area will expand as technical capability expands.

3.2 LOCAL SERVING AREA

The area in which the Company has the capability to provide Residence Local Service. This Local Serving Area is defined by maps following this Section.

3.3 LOCAL CALLING AREA

The area in which a Customer of Residence Local Service may complete calls without a toll charge.

ISSUED: DECEMBER 27, 2004

EFFECTIVE: JANUARY 1, 2005

LOCAL SERVING AREAS AND LOCAL CALLING AREAS

3.4 LIST OF LOCAL SERVING AREAS AND LOCAL CALLING AREAS

Listed below are Local Serving Areas and the corresponding Local Calling Areas in which customers may complete calls without a toll charge.

LOCAL SERVING AREA	LOCAL CALLING AREA
Alpine	American Fork, Goshen, Lehi, Orem, Payson, Pleasant Grove, Provo, Salem, Santaquin, Spanish Fork, Springville
Centerville	Bountiful, Cottonwood, Draper, Farmington, Holladay, Kaysville, Kearns, Magna, Midvale, Murray, Riverton, Salt Lake City, North Salt Lake City, South Salt Lake City.
Clinton	Clearfield, East Layton, Huntsville, Kaysville, Morgan, Mountain Green, Ogden.
Draper	Bountiful, Cottonwood, Draper, Farmington, Holladay, Kearns, Magna, Midvale, Riverton, Salt Lake City, North Salt Lake City, South Salt Lake City
Harrisville	Clearfield, East Layton, Huntsville, Kaysville, Morgan, Mountain Green, Ogden.

ISSUED: DECEMBER 27, 2004

EFFECTIVE: JANUARY 1, 2005

LOCAL SERVING AREAS AND LOCAL CALLING AREAS

3.4 LIST OF LOCAL SERVING AREAS AND LOCAL CALLING AREAS (CONT'D)

LOCAL SERVING AREA	LOCAL CALLING AREA
Herriman	Bountiful, Cottonwood, Draper, Holladay, Kearns, Magna, Midvale, Murray, Riverton, Salt Lake City, North Salt Lake City, South Salt Lake City
Holladay	Bountiful, Cottonwood, Draper, Kearns, Magna, Midvale, Murray, Riverton, Salt Lake City, North Salt Lake City, South Salt Lake City
Kearns	Bountiful, Cottonwood, Draper, Holladay, Magna, Midvale, Murray, Riverton, Salt Lake City, North Salt Lake City, South Salt Lake City
Magna	Bountiful, Cottonwood, Draper, Holladay, Kearns, Midvale, Murray, Riverton, Salt Lake City, North Salt Lake City, South Salt Lake City
Murray	Bountiful, Cottonwood, Draper, Farmington, Holladay, Kearns, Magna, Midvale, Riverton, Salt Lake City, North Salt Lake City, South Salt Lake City

LOCAL SERVING AREAS AND LOCAL CALLING AREAS

3.4 LIST OF LOCAL SERVING AREAS AND LOCAL CALLING AREAS (CONT'D)

LOCAL SERVING AREA	LOCAL CALLING AREA
North Ogden	Clearfield, East Layton, Huntsville, Kaysville, Morgan, Mountain Green, Ogden
North Salt Lake City	Bountiful, Cottonwood, Draper, Farmington, Holladay, Kaysville, Kearns, Magna, Midvale, Murray, Riverton, Salt Lake City, North Salt Lake City, South Salt Lake City
Ogden City	Clearfield, East Layton, Huntsville, Kaysville, Morgan, Mountain Green, Ogden
Orem	American Fork, Goshen, Heber, Lehi, Payson, Pleasant Grove, Provo, Salem, Santaquin, Spanish Fork, Springville
900 Bitner Road Park City	Park City, Snyderville Basin
Park City	Park City, Snyderville Basin
Provo City	American Fork, Goshen, Heber, Lehi, Orem, Payson, Pleasant Grove, Salem, Santaquin, Spanish Fork, Springville
Riverdale	Clearfield, East Layton, Huntsville, Kaysville, Morgan, Mountain Green, Ogden.
Salt Lake City	Bountiful, Cottonwood, Draper, Farmington, Holladay, Kaysville, Kearns, Magna, Midvale, Murray, Riverton, Salt Lake City, North Salt Lake City, South Salt Lake City

LOCAL SERVING AREAS AND LOCAL CALLING AREAS

3.4 LIST OF LOCAL SERVING AREAS AND LOCAL CALLING AREAS (CONT'D)

LOCAL SERVING AREA	LOCAL CALLING AREA
48 West 300 South Salt Lake City	Bountiful, Cottonwood, Draper, Farmington, Holladay, Kaysville, Kearns, Magna, Midvale, Murray, Riverton, Salt Lake City, North Salt Lake City, South Salt Lake City
731 South 300 East Salt Lake City	Bountiful, Cottonwood, Draper, Farmington, Holladay, Kaysville, Kearns, Magna, Midvale, Murray, Riverton, Salt Lake City, North Salt Lake City, South Salt Lake City
2200 Foothill Drive Salt Lake City	Bountiful, Cottonwood, Draper, Farmington, Holladay, Kaysville, Kearns, Magna, Midvale, Murray, Riverton, Salt Lake City, North Salt Lake City, South Salt Lake City
1155 East 2100 South Salt Lake City	Bountiful, Cottonwood, Draper, Farmington, Holladay, Kaysville, Kearns, Magna, Midvale, Murray, Riverton, Salt Lake City, North Salt Lake City, South Salt Lake City
9600 South 225 West Sandy	Bountiful, Cottonwood, Draper, Farmington, Holladay, Kaysville, Kearns, Magna, Midvale, Murray, Riverton, Salt Lake City, North Salt Lake City, South Salt Lake City

ISSUED: DECEMBER 27, 2004

EFFECTIVE: JANUARY 1, 2005

LOCAL SERVING AREAS AND LOCAL CALLING AREAS

3.4 LIST OF LOCAL SERVING AREAS AND LOCAL CALLING AREAS (CONT'D)

LOCAL SERVING AREA	LOCAL CALLING AREA
9425 South Riverside Drive Sandy	Bountiful, Cottonwood, Draper, Farmington, Holladay, Kaysville, Kearns, Magna, Midvale, Murray, Riverton, Salt Lake City, North Salt Lake City, South Salt Lake City
South Ogden City	Clearfield, East Layton, Huntsville, Kaysville, Morgan, Mountain Green, Ogden.
South Salt Lake City	Bountiful, Cottonwood, Draper, Farmington, Holladay, Kaysville, Kearns, Magna, Midvale, Murray, Riverton, Salt Lake City, North Salt Lake City, South Salt Lake City
Spanish Fork	American Fork, Goshen, Lehi, Orem, Payson, Pleasant Grove, Provo, Salem, Santaquin, Springville
Sunset	Clearfield, East Layton, Huntsville, Kaysville, Morgan, Mountain Green, Ogden.
Taylorsville	Bountiful, Cottonwood, Draper, Farmington, Holladay, Kearns, Magna, Midvale, Riverton, Salt Lake City, North Salt Lake City, South Salt Lake City

ISSUED: DECEMBER 27, 2004

EFFECTIVE: JANUARY 1, 2005

LOCAL SERVING AREAS AND LOCAL CALLING AREAS

3.4 LIST OF LOCAL SERVING AREAS AND LOCAL CALLING AREAS (CONT'D)

LOCAL SERVING AREA	LOCAL CALLING AREA
Washington Terrace	Clearfield, East Layton, Huntsville, Kaysville, Morgan, Mountain Green, Ogden.
West Bountiful	Bountiful, Cottonwood, Draper, Farmington, Holladay, Kaysville, Kearns, Magna, Midvale, Murray, Riverton, Salt Lake City, North Salt Lake City, South Salt Lake City.
Woodscross	Bountiful, Cottonwood, Draper, Farmington, Holladay, Kaysville, Kearns, Magna, Midvale, Murray, Riverton, Salt Lake City, North Salt Lake City, South Salt Lake City.
West Valley City	Bountiful, Cottonwood, Draper, Farmington, Holladay, Kearns, Magna, Midvale, Murray, Riverton, Salt Lake City, North Salt Lake City, South Salt Lake City

LOCAL SERVING AREAS AND LOCAL CALLING AREAS

3.5 LOCAL SERVING AREA MAPS

3.5.1 GENERAL

The following maps indicate the Company's Local Serving Areas.

- DPU1 - Salt Lake City
- DPU2 - Ogden
- DPU3 - Provo, Orem
- DPU4 - Draper
- DPU5 - So. Salt Lake City, Kearns, Magna, Murray, Taylorsville, West Valley City
- DPU6 - Spanish Fork
- DPU7 - Centerville, West Bountiful
- DPU8 - Herriman
- DPU9 - Park City
- DPU10 - Alpine
- DPU11 - Reserved for Future Use

ISSUED: DECEMBER 27, 2004

EFFECTIVE: JANUARY 1, 2005

LOCAL SERVING AREAS AND LOCAL CALLING AREAS

3.5 LOCAL SERVING AREA MAPS

DPU1 – SALT LAKE CITY

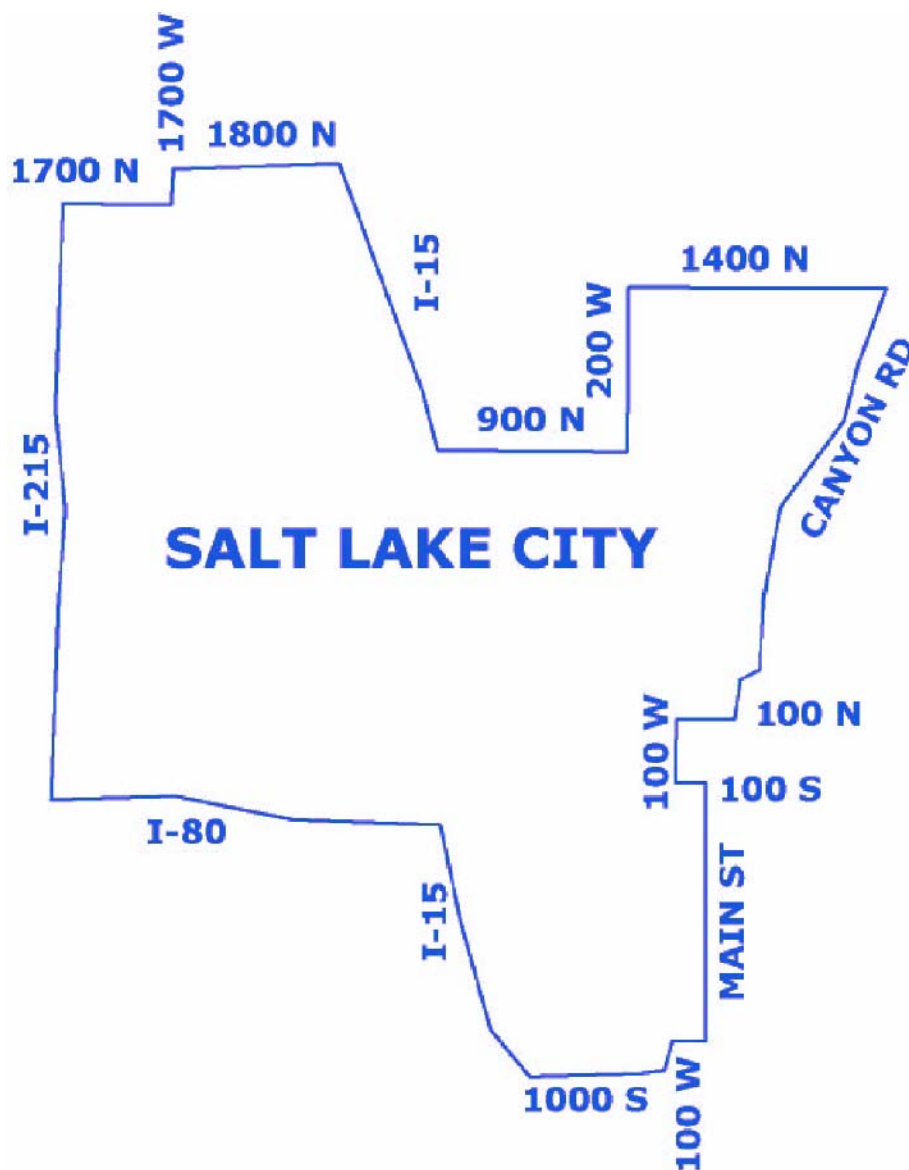

ISSUED: DECEMBER 27, 2004

EFFECTIVE: JANUARY 1, 2005

LOCAL SERVING AREAS AND LOCAL CALLING AREAS

3.5 LOCAL SERVING AREA MAPS

DPU2 – OGDEN

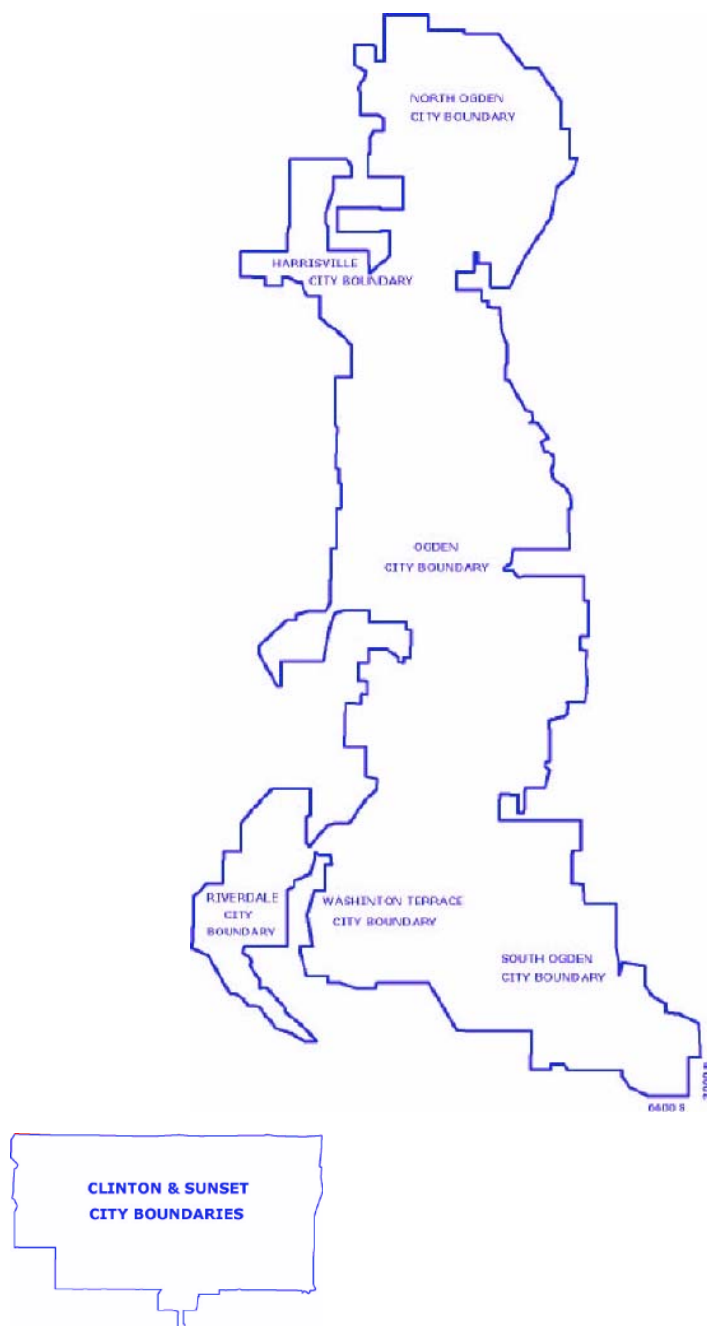

ISSUED: DECEMBER 27, 2004

EFFECTIVE: JANUARY 1, 2005

LOCAL SERVING AREAS AND LOCAL CALLING AREAS

3.5 LOCAL SERVING AREA MAPS

DPU3 – PROVO, OREM

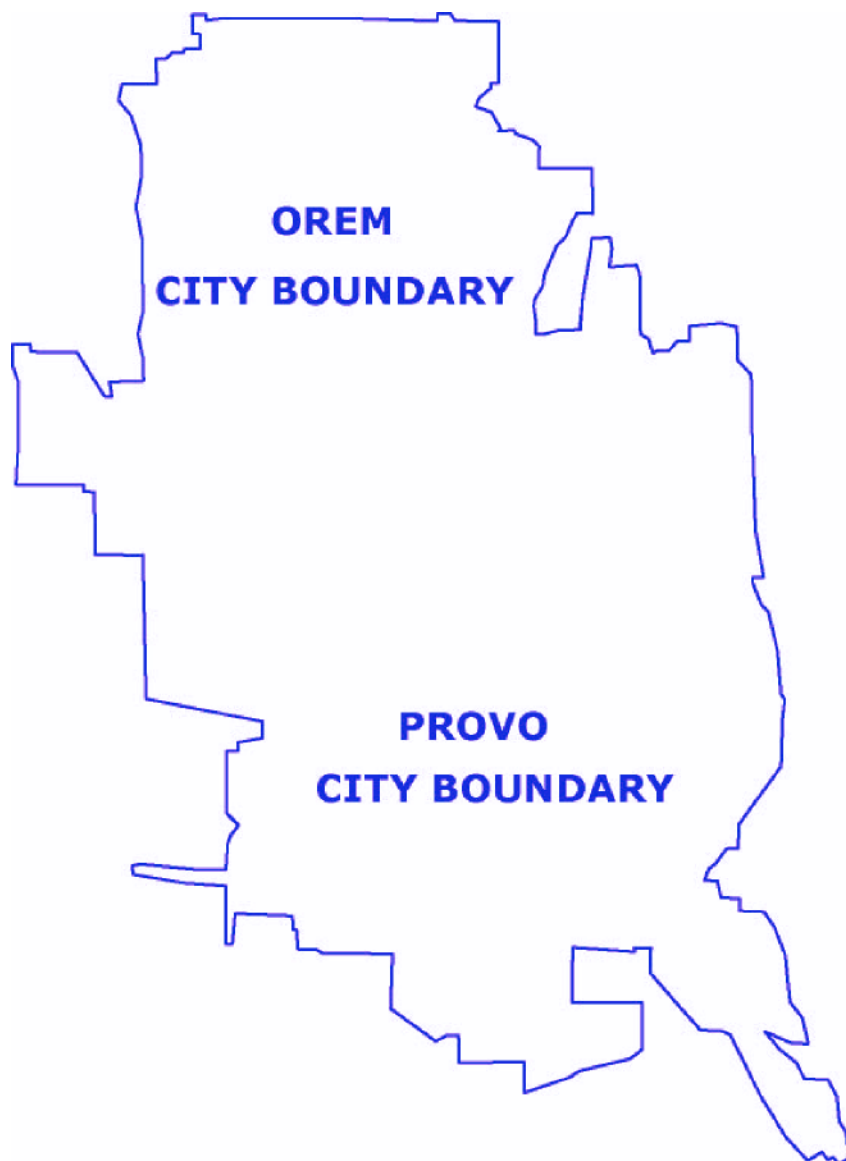

ISSUED: DECEMBER 27, 2004

EFFECTIVE: JANUARY 1, 2005

LOCAL SERVING AREAS AND LOCAL CALLING AREAS

3.5 LOCAL SERVING AREA MAPS

DPU4 – DRAPER

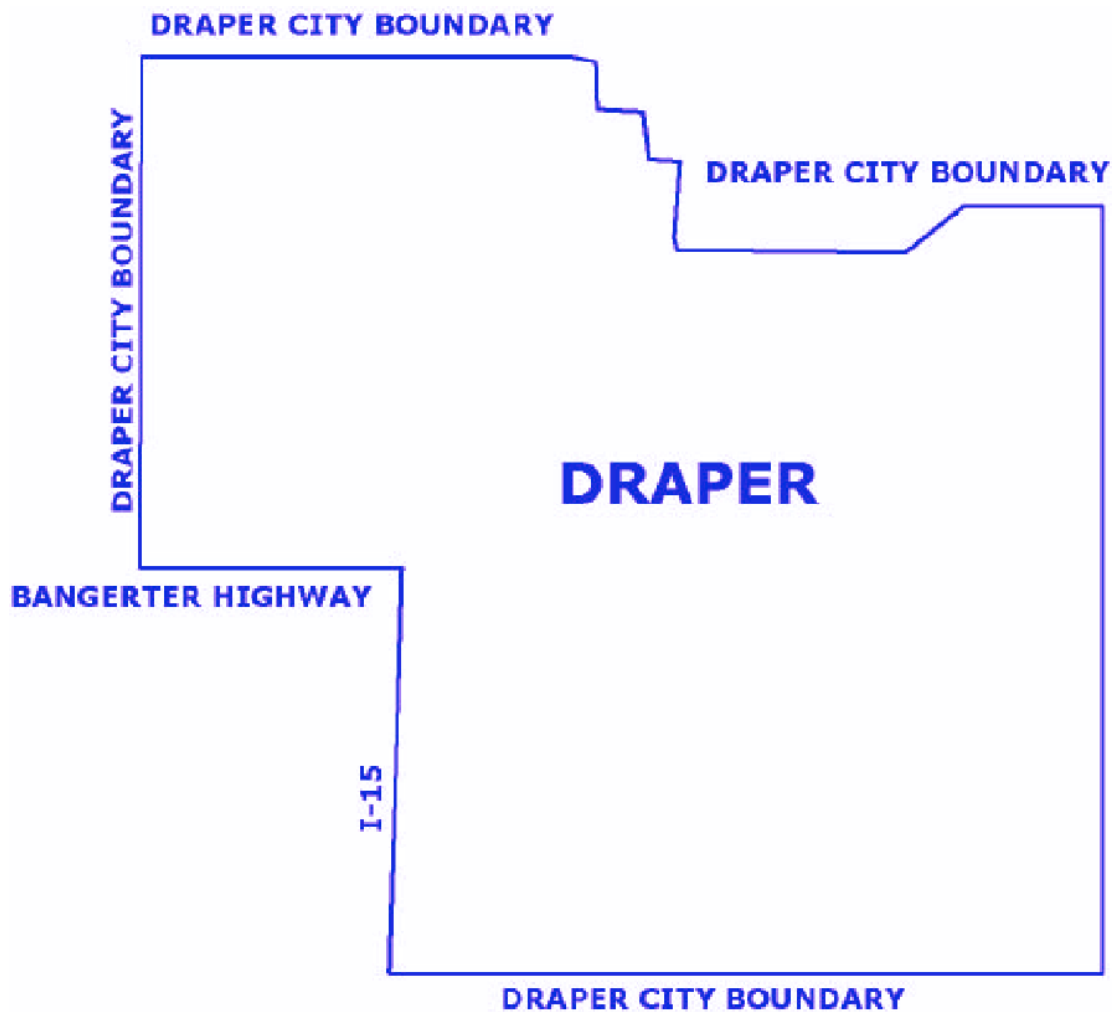

ISSUED: DECEMBER 27, 2004

EFFECTIVE: JANUARY 1, 2005

LOCAL SERVING AREAS AND LOCAL CALLING AREAS

3.5 LOCAL SERVING AREA MAPS

DPU5 – S. SALT LAKE CITY, KEARNS, MAGNA, MURRAY, TAYLORSVILLE, WEST VALLEY CITY

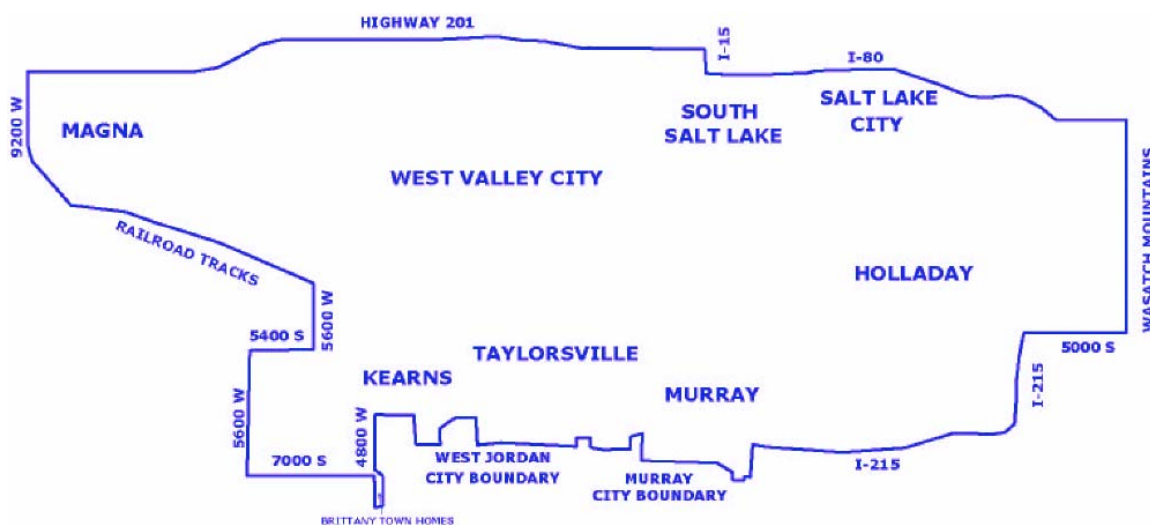

ISSUED: DECEMBER 27, 2004

EFFECTIVE: JANUARY 1, 2005

LOCAL SERVING AREAS AND LOCAL CALLING AREAS

3.5 LOCAL SERVING AREA MAPS

DPU6 – SPANISH FORK

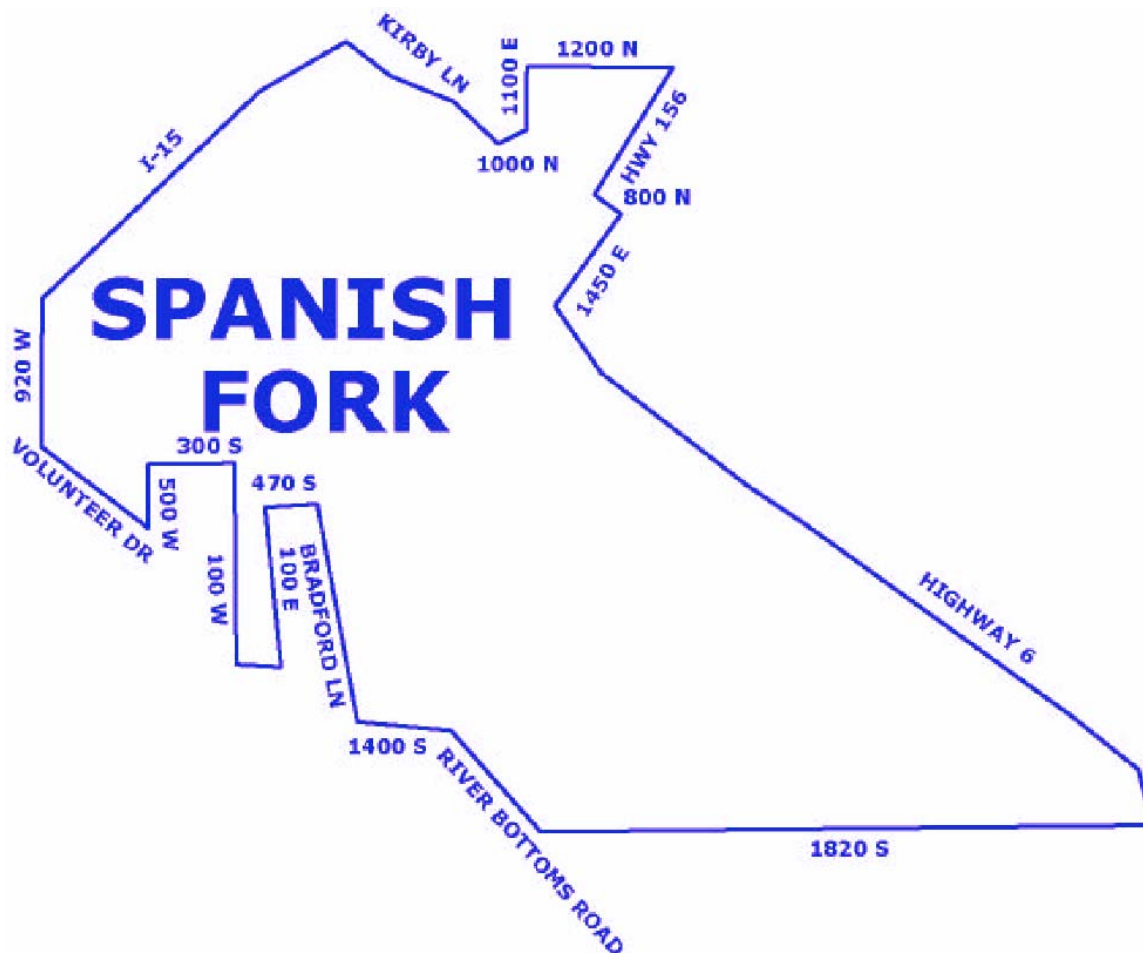

ISSUED: DECEMBER 27, 2004

EFFECTIVE: JANUARY 1, 2005

LOCAL SERVING AREAS AND LOCAL CALLING AREAS

3.5 LOCAL SERVING AREA MAPS

DPU7 – CENTERVILLE, WEST BOUNTIFUL

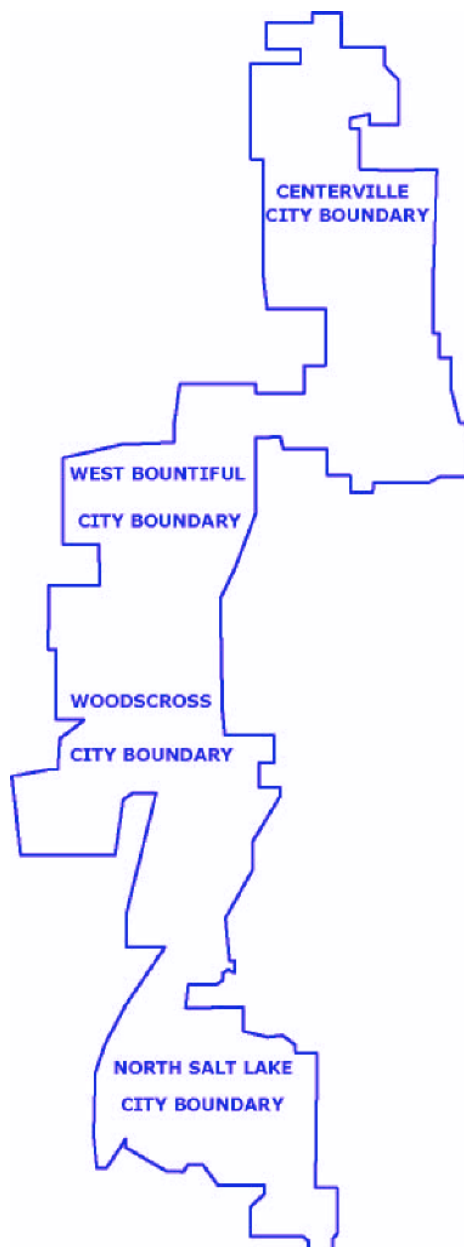

ISSUED: DECEMBER 27, 2004

EFFECTIVE: JANUARY 1, 2005

LOCAL SERVING AREAS AND LOCAL CALLING AREAS

3.5 LOCAL SERVING AREA MAPS

DPU8 – HERRIMAN

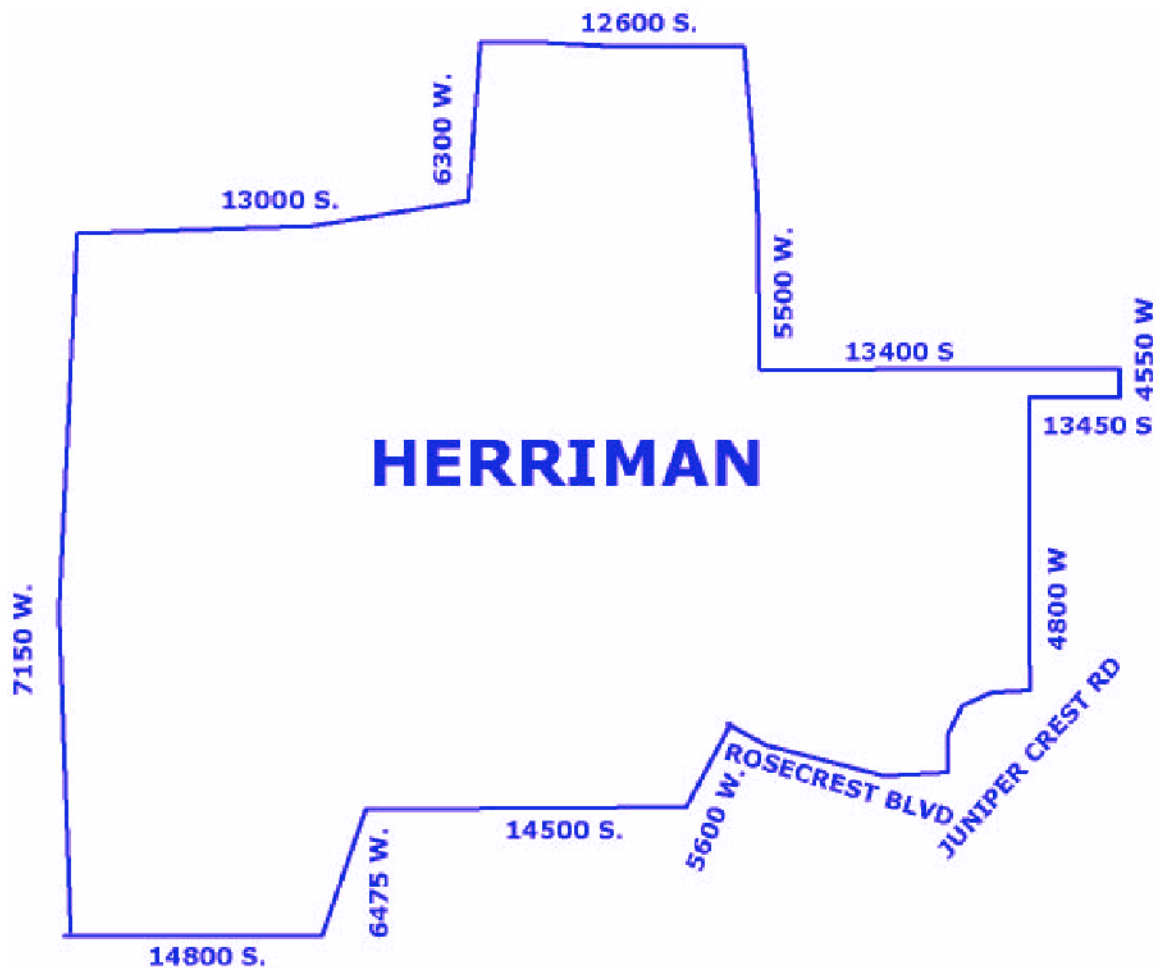

ISSUED: DECEMBER 27, 2004

EFFECTIVE: JANUARY 1, 2005

LOCAL SERVING AREAS AND LOCAL CALLING AREAS

3.5 LOCAL SERVING AREA MAPS

DPU9 – PARK CITY

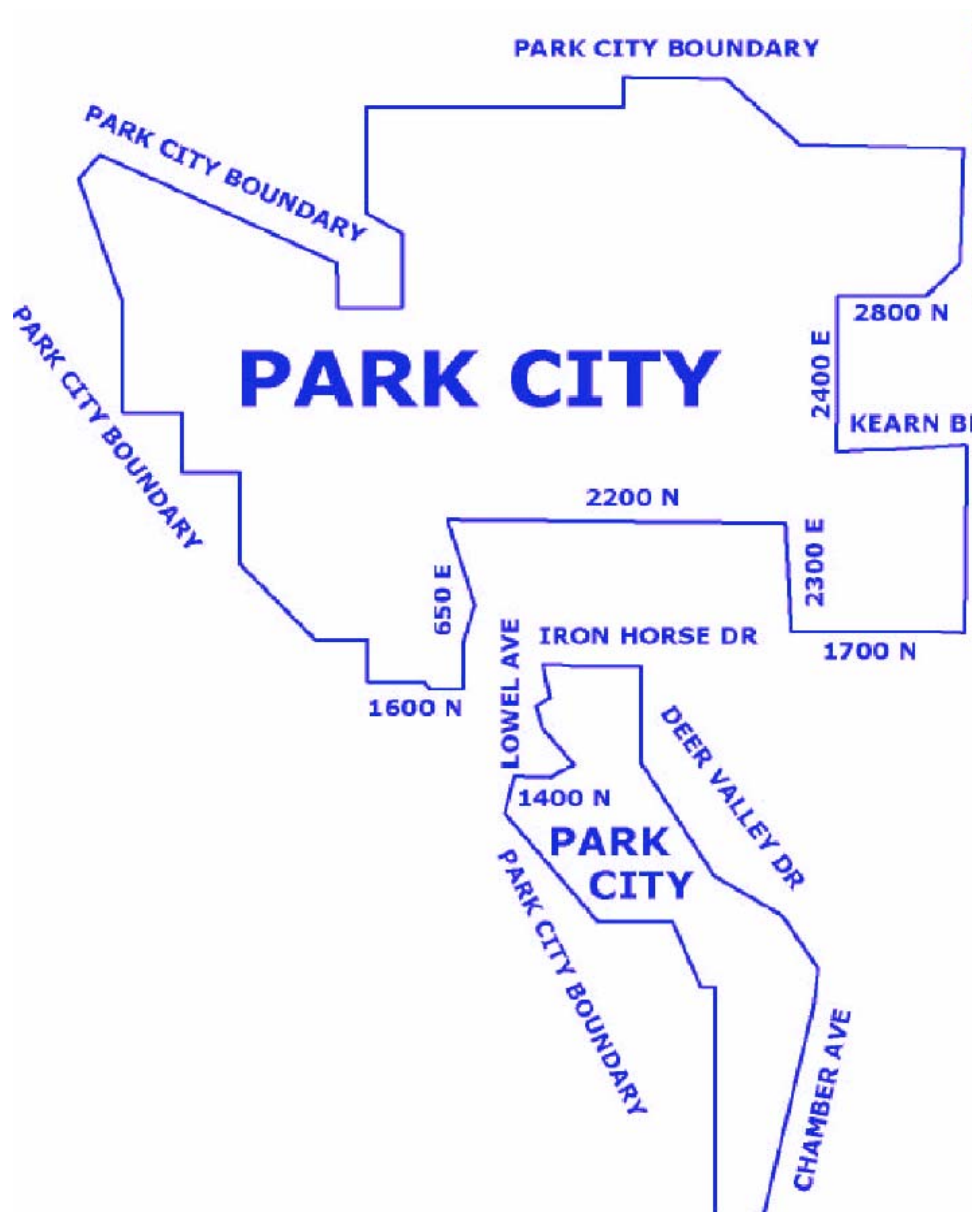

ISSUED: DECEMBER 27, 2004

EFFECTIVE: JANUARY 1, 2005

LOCAL SERVING AREAS AND LOCAL CALLING AREAS

3.5 LOCAL SERVING AREA MAPS

DPU10 – ALPINE

